

EXISTING AIRPORT FACILITIES			EXISTING AGRICULTURAL FACILITIES			LEGEND	
NO	FACILITY	ROOM NO.	FACILITY	ROOM NO.	ITEM	EXISTING	FUTURE
21	Airport Administration Building	914.8	148 Swine Evaluation Station	910.0	Existing Airport Property Line	---	---
31	Tug Garage	941.6	2011 Laboratory Animal Ctr. Bld. 1	880.0	Security Fence	---	---
143	Fuel Farm Building	912.1	202 Laboratory Animal Ctr. Bld. 2	883.0	Airfield Pavement	---	---
195	T-Hanger No. 1 "B"	922.8	203 Laboratory Animal Ctr. Bld. 3	873.3	Building	---	---
196	T-Hanger No. 2 "A"	916.5	204 Laboratory Animal Ctr. Bld. 4	855.7	Railroad	---	---
197	T-Hanger No. 3 "A"	915.9	286 Straw Shed	909.5	Windcone	---	---
198	Hanger No. 4	944.8	318 Straw Barn	920.2	Airport Reference Point	---	---
199	Aeronautical & Astronautical Lab	921.2	319 Farm Shop	923.5	NAVADS	---	---
235	Flight Laboratory Hanger	928.4	320 Machine Storage	919.5	Ground Contours (10 Ft.)	---	---
236	Hanger 1.2 and 3	922.8	322 Hay Storage	922.5	Surface Drainage	---	---
237	Airport Storage Building	925.2	323 Horse Barn	940.5	Redding Beacon EL. 938.6	---	---
238	Airport Storage Building	925.6	324 Coil Barn	971.5	Power Line	---	---
239	Hanger No. 7	936.5	325 Cow Barn	972.5	Wooded Area	---	---
256	Hanger No. 8	954.7	326 Swine Barn	926.0	Helipad	---	---
285	Airport Terminal Building	925.1	327 Waste Treatment	926.0	REPZ	---	---
900	Hanger No. 9	951.5	333 Range Shelter 1	921.5	Equipment Critical Area	---	---
901	T-Hanger No. 4 "C"	954.1	334 Range Shelter 2	922.0	Existing Avigation Easement	---	---
904	T-Hanger No. 5 "D"	893.7	335 Range Shelter 3	923.0	Runway Centerline	---	---
973	FMA Air Traffic Control Tower	968.8	356 Swine Station Storage Building	913.0	RSA	---	---
1000	ODOT Office of Aviation Hanger	929.0	361 Beef Barn	908.8	ORA	---	---
1001	Med Flight Hanger	920.0	957 USDA Machine Storage Building	914.0			
1002	Airport Storage Building	910.0	982 Farm Science Review Building	917.0			
1003	Airport Storage Building	910.0	991 Equipment Storage Building	911.0			
1004	Airport Storage Building	910.0	1011 Residence	920.0			
1007	O.S.U. Fuel Farm	grade					
1009	ODOT Fuel Farm	grade					
1112	Joint Use Fire Station	920.0					
1113	Airport Maintenance	920.0					
1114	Home Depot - Sign on roof	951.0					

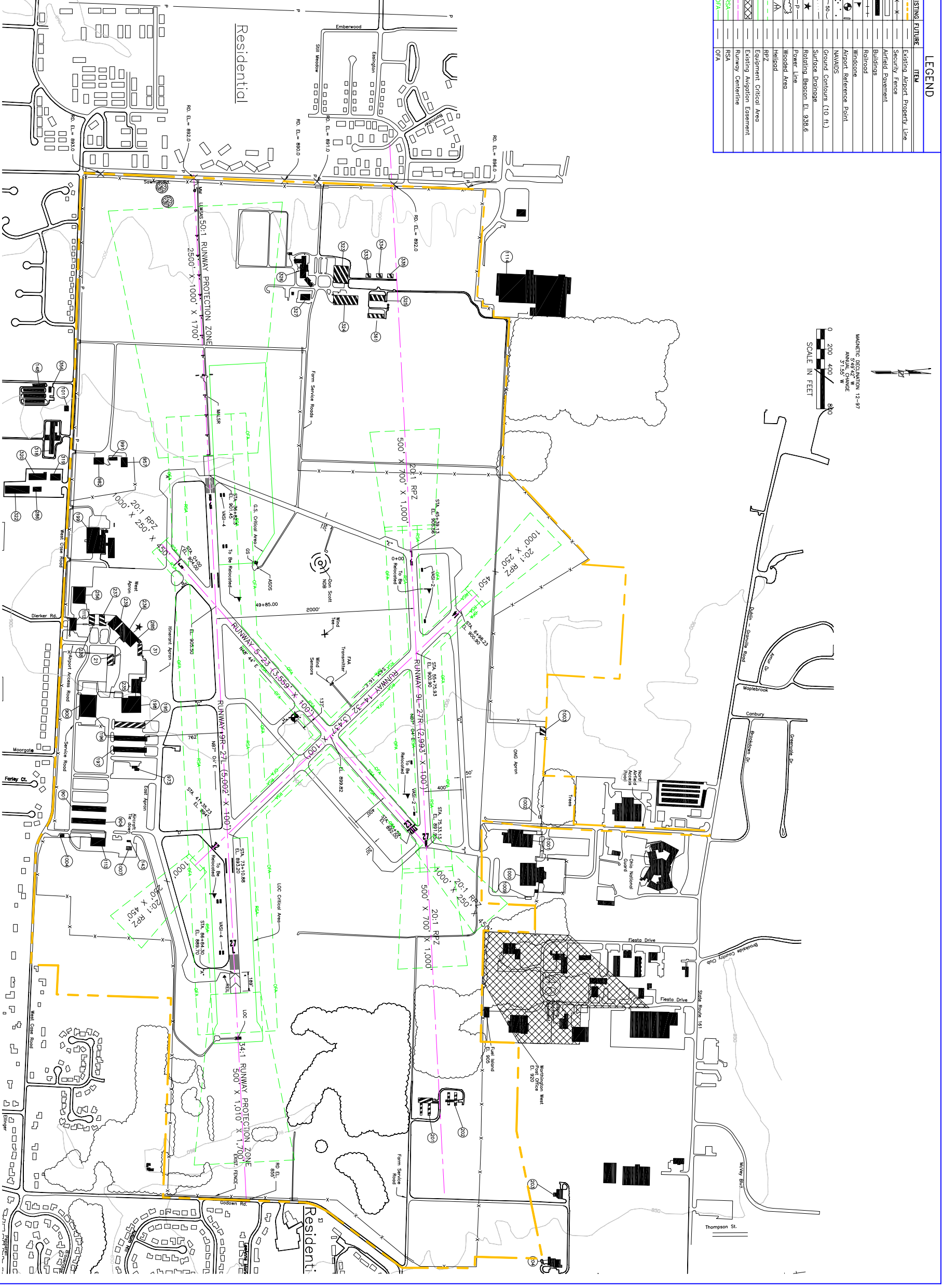

Wilbur Smith Associates
 Engineers
 Planners
 Economists

WILBUR SMITH ASSOCIATES
 6600 CLOUGH PIKE
 CINCINNATI, OH 45244
 TEL (513)233-3700 FAX (513)624-5182

OSU CONTRACT NO.	
WSA PROJECT NUMBER:	...
POZ PROJECT NUMBER:	5831
DRAWN BY:	P.M.
CHECKED BY:	J.K.
DATE:	12/12/00

Note:
 Airport Layout Plan based on Current Aerial Photography. Before any Engineering Design or Construction Projects are undertaken the exact location of all facilities should be field checked.

NO.	DATE	REVISIONS

THE OHIO STATE UNIVERSITY
 AIRPORT
 AIRPORT LAYOUT PLAN - AS BUILT
 CONDITIONS AS OF NOVEMBER 2005
 R. D. Zande & Associates, Inc.
 1237 Dublin Road
 Columbus, Ohio 43215
 Phone: (614) 496-4383

SCALE: 1" = 400'
 DATE: 10/04/02 3/13